

River Courses

1. S 10. E 36.
2. S 6. W 26.
3. S 7. E 16.
4. S 18 1/2 E 18.
5. S 24 1/2 E 22.
6. S 17. E 63.
7. S 6. W 54.
8. S 11. W 27.
9. S 28. W 12 1/2.
10. S 32. W 9.
11. S 42. W 22.
12. S 54 1/2 W 3.
13. S 52 1/2 W 26.
14. S 50. W 46.
15. S 27. W 13.
16. S 34. W 6 1/2.
17. S 25. W 16.
18. S 15. W 18.
19. S 26. W 6.
20. S 21. W 25 1/2.

Reversed the river courses for calculation.

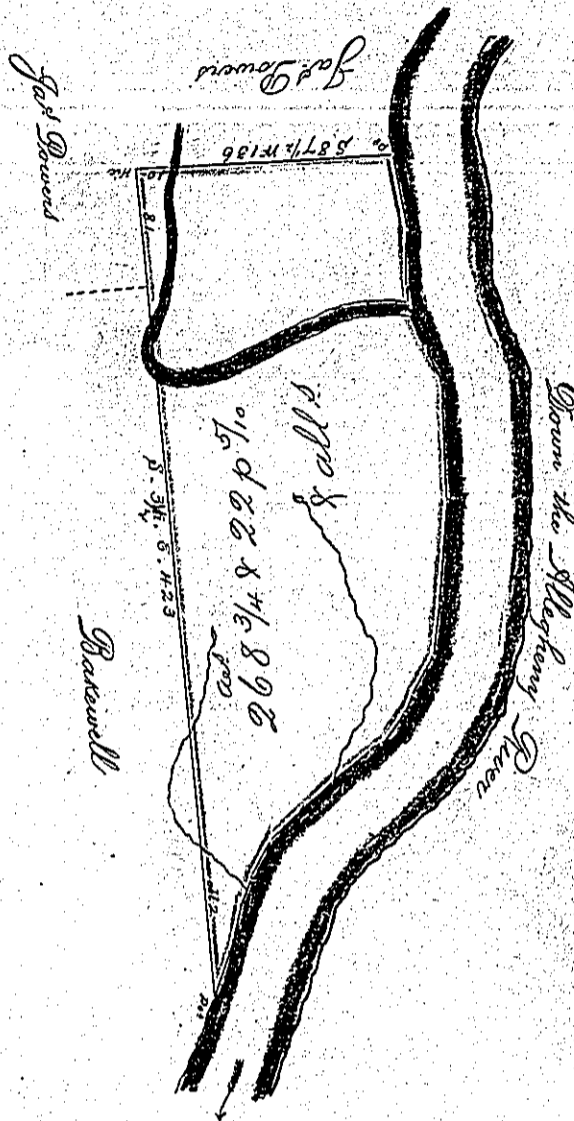

In pursuance of a Warrant dated the 9th of January 1824 Surveyed for Joseph Jessup, the above described Tract of Land containing Three hundred & Sixty Eight ^{and} Three Rods & twenty two perches 3/4 of a perch with an allowance of 6 p. Situate in Indiana Township in the County of Allegheny North West of Allegheny River. Survey'd Feb^r 12th A.D. 1824 p^r

Rob^t Beatty D^s

Sam^l Cochran Esq^r
Surveyor Gen^l Penn^a

IN TESTIMONY that the above is a copy of the original remaining on file in the Department of Internal Affairs of Pennsylvania, made conformably to an Act of Assembly approved the 16th day of February, 1833, I have hereunto set my Hand and caused the Seal of said Department to be affixed at Harrisburg, this



Seventh day of February 1899

James W. Pitts
Secretary of Internal Affairs